

5. Installation of Transmitter

5.1 Compact
(Integral)
IP 67
version

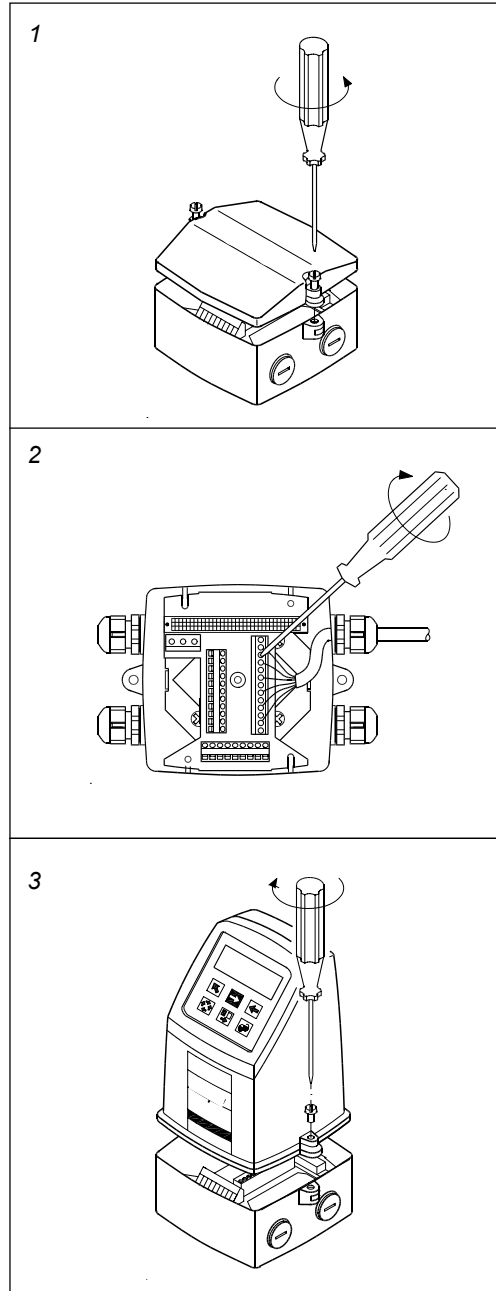

Remove and discard the terminal box cover of the sensor.

Fit the Pg 13.5 cable glands for the supply and output cables. (13.5 X 1/2 NPT adapters are supplied with each unit. FCI part number 017945-01).

Fit the supply and output cables respectively and tighten the cable glands to obtain optimum sealing.

Please see the wiring diagram for the "Electrical connections".

Mount the signal converter on the terminal box.

Installation of signal con.

Turning the control pad

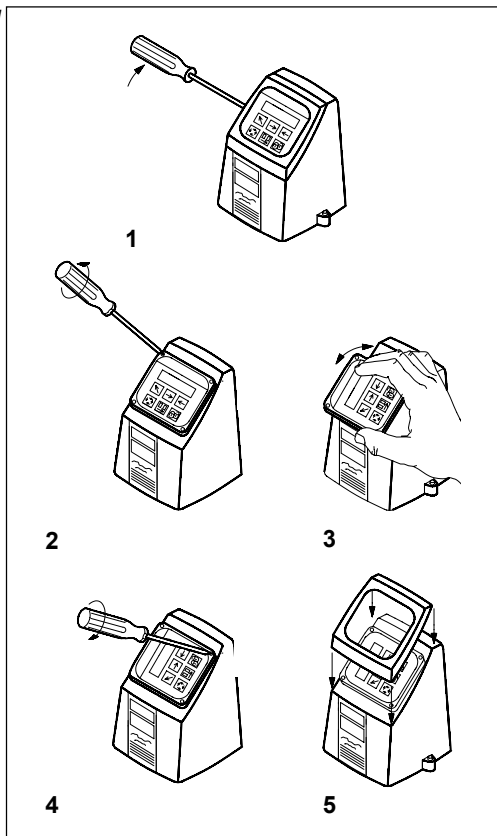

1. Remove the outer frame using a fingernail or a screwdriver.
2. Loosen the 4 screws retaining the control pad.
3. Withdraw the control pad and turn it to the required orientation.
4. Tighten the 4 screws until a mechanical stop is felt in order to obtain IP 67 enclosure rating.
5. Snap-lock the outer frame onto the control pad (click).

Turning the transmitter

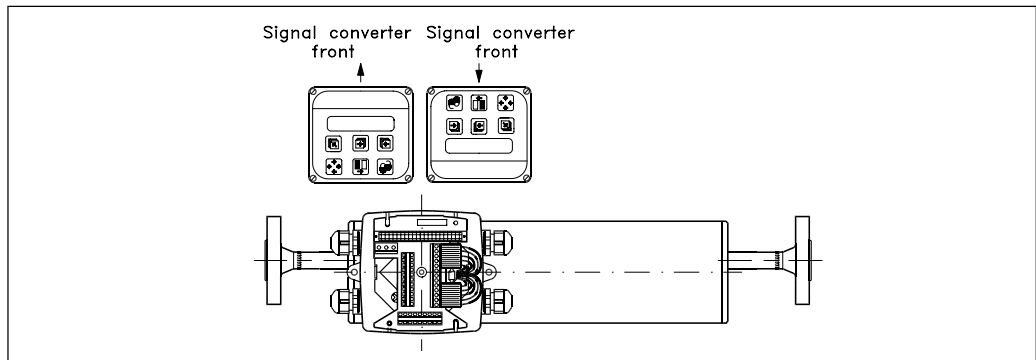

The transmitter can be mounted in either direction as the arrow indicates by turning the PCB but without turning the terminal box.

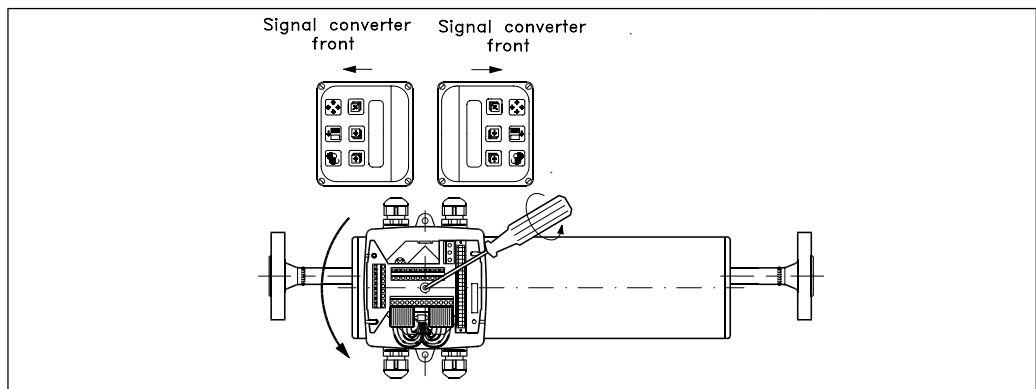

The terminal box can be rotated $\pm 90^\circ$ in order to optimize the viewing angle of the transmitter display/keypad:
 Unscrew the four screws in the bottom of the terminal box. Turn the terminal box to the required position and re-tighten the screws firmly.

5.2.1 Add-on modules

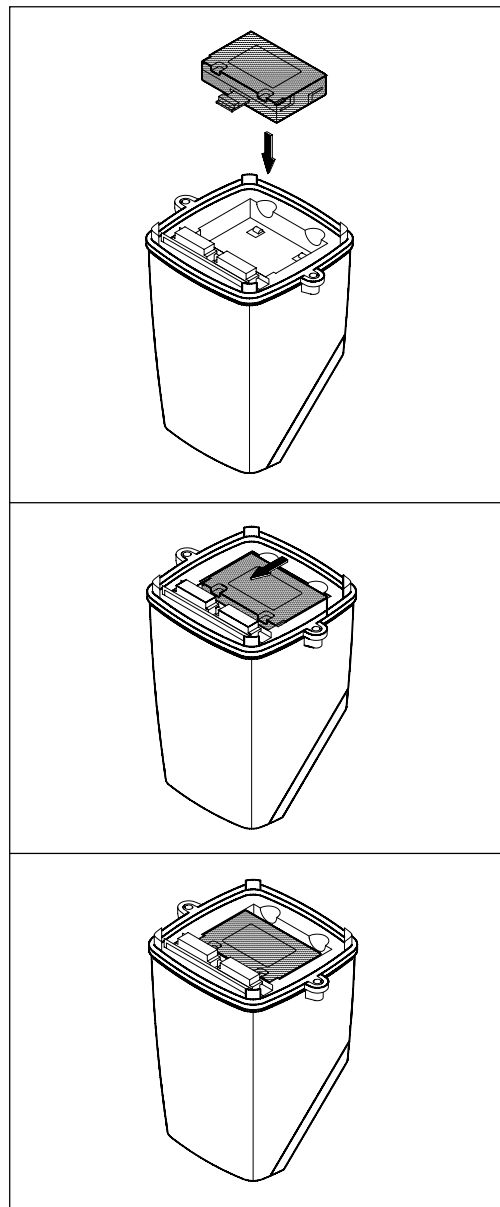

Unpack the add-on modules and locate it in the bottom of the transmitter as shown.

Press the add-on module forward as far as possible.

The add-on module has now been installed. The transmitter is ready to be installed on the terminal box. Communication to the operator menu and electrical inputs and outputs are automatically established at power on.

Installation of signal con.

5.2.2 Remote installation
 Wall mounting
 Compact (Integral)
 IP 67 version

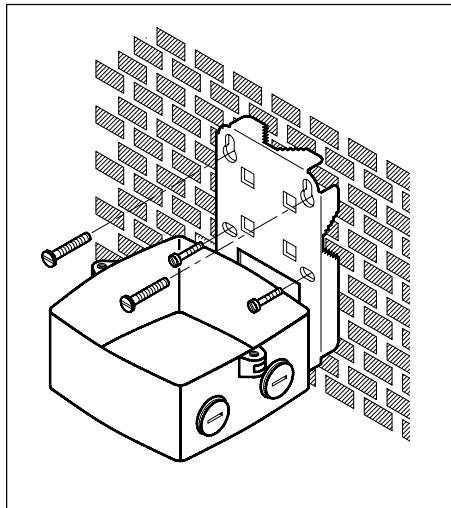

Mount the wall bracket on a wall, pipe or in the back of a panel.

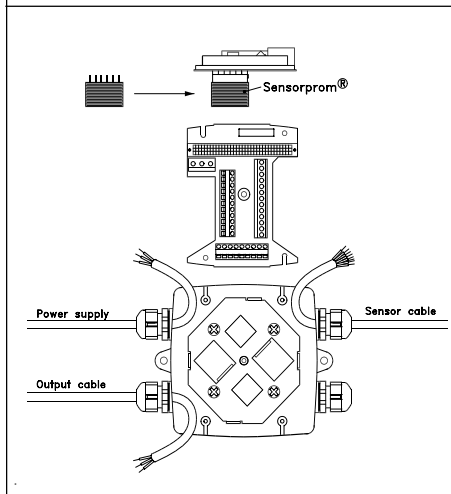

Take the SENSORPROM® unit from the sensor. Mount the SENSORPROM® unit in the wall mounting unit as shown. The label on the SENSORPROM® unit must face the wall bracket.

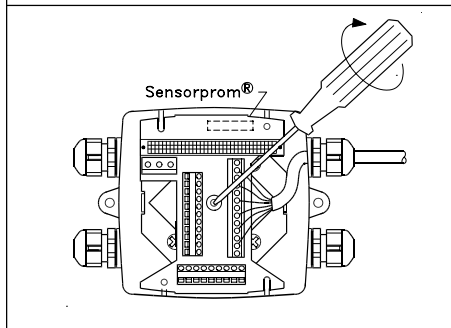

Mount the connection plate in the terminal box. Tighten the earth ground screw in the center of the connection box properly.

Fit the sensor, supply and output cables respectively and tighten the cable glands to obtain optimum sealing. See the wiring diagram for the "Electrical connections".

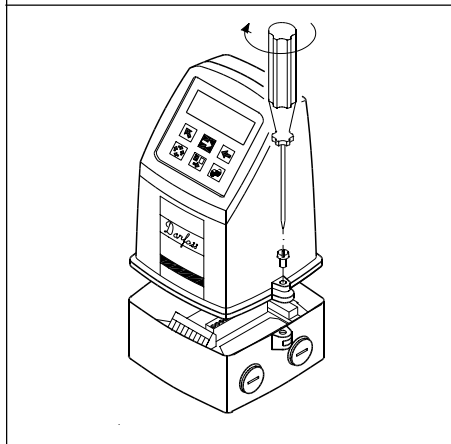

Mount the transmitter on the terminal box.

Installation of signal con.

**5.2.3 Compact(Integral)
IP 67
Installation/
exchange of
SENSORPROM®
memory unit**

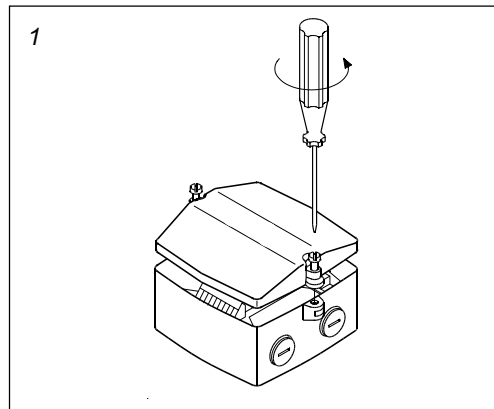

The SENSORPROM® unit is delivered mounted in the terminal box of the sensor as shown.

To remove the SENSORPROM® unit, the following procedure must be followed:

Remove the terminal box cover of the sensor, or remove the transmitter, if it has been installed.

Remove the connection plate in the terminal box by unscrewing the earth grounding screw in the center as shown.

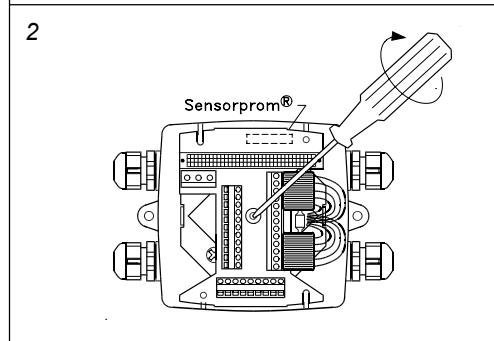

The SENSORPROM® unit is located in the bottom of the terminal box and can be removed. Note the orientation.

To re-assemble, mount the connection plate in the terminal box and tighten the earth grounding screw.

The label on the SENSORPROM® unit **must** face the wall bracket.

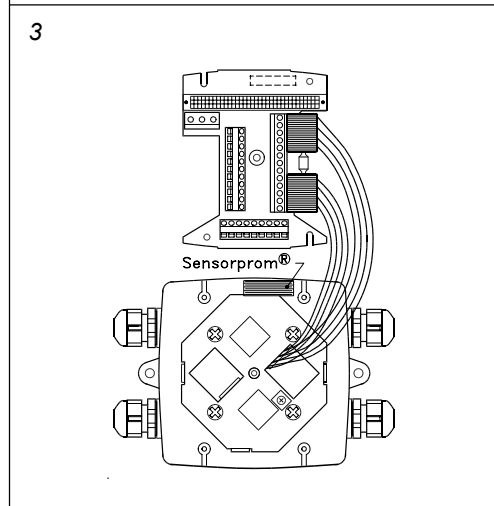

Mount the transmitter on the terminal box.

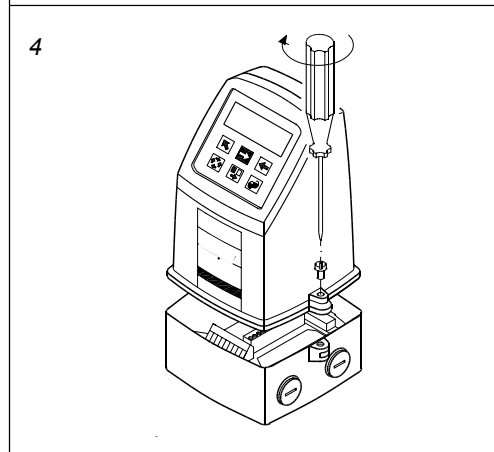

Installation of signal con.

5.2.4 Remote installation
Signal converter in
19" insert

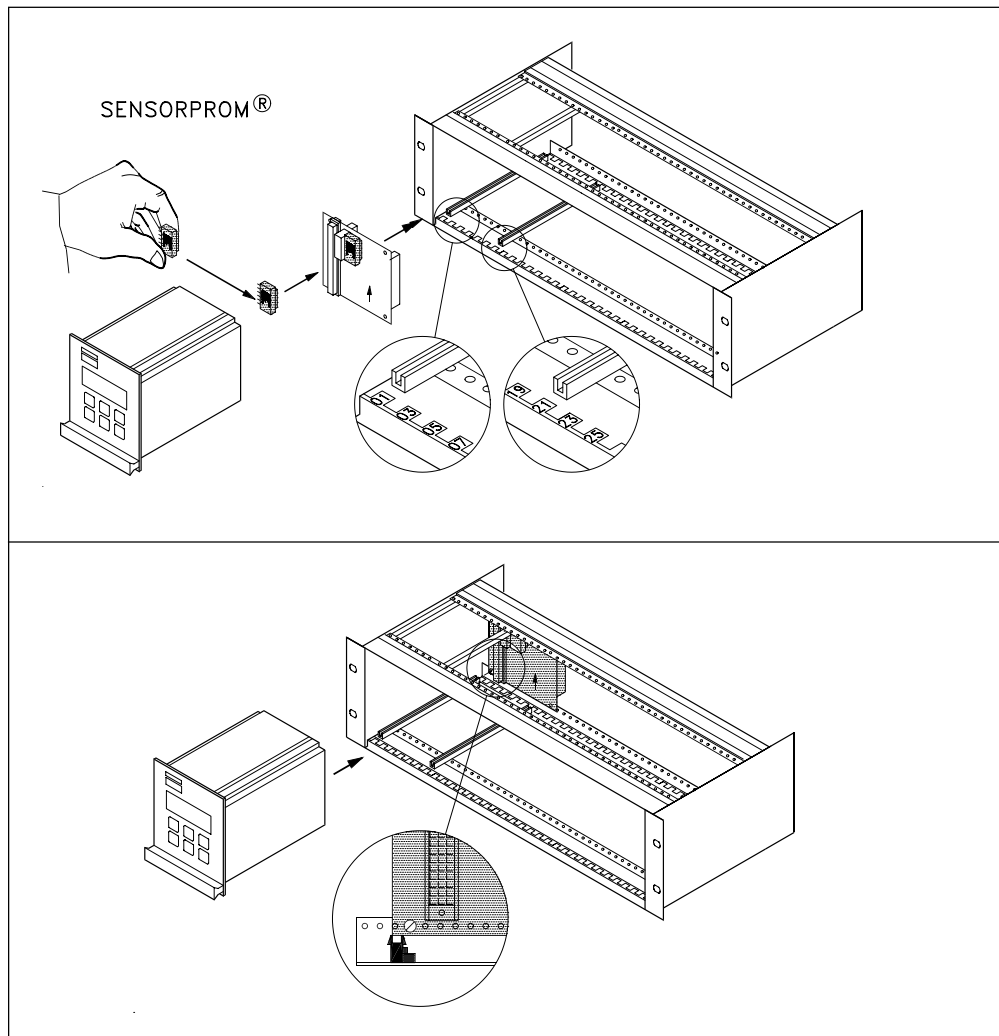

1. Fit the SENSORPROM® unit on the connection board supplied with the transmitter. The SENSORPROM® unit is supplied with the sensor.
2. Mount the guide rails in the rack system as shown. Distance between guide rails is 21 TE. Guide rails are supplied with the rack system and not with the transmitter.
3. Mount the connection board as shown. The mounting screw must be installed in line with the guide rails.
4. Connect the cables as shown under "Electrical connection".
5. Plug the transmitter into the rack system.

5.2.5 Installation in wall mounting enclosure

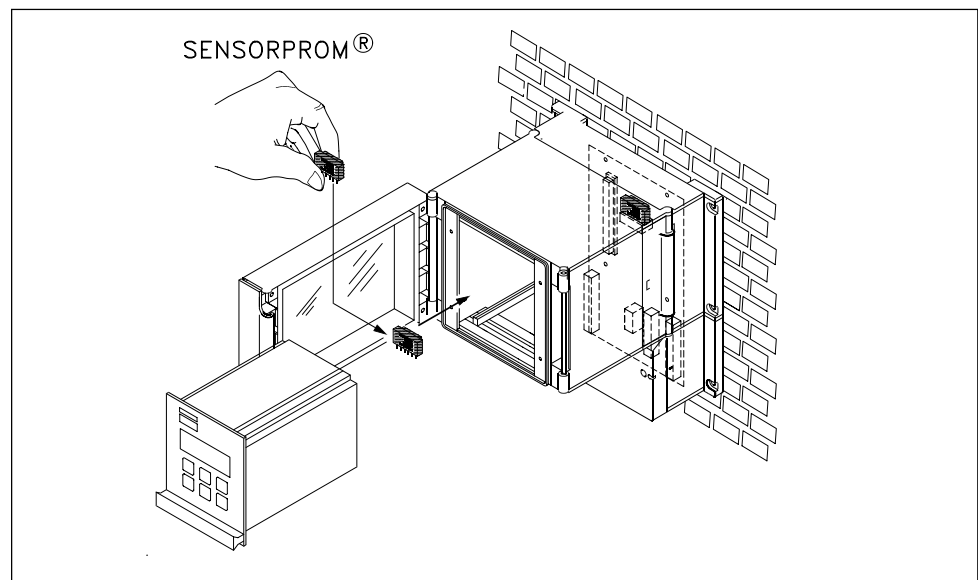

1. Mount the enclosure to the wall with four screws.
2. Mount the SENSORPROM® unit on the connection board as shown. The SENSORPROM® unit is supplied with the sensor in the terminal box. The connection board for IP 65 wall mounting boxes must be used.
3. Connect the cables to the terminals, see "Electrical connection".
4. Plug in the transmitter and close the cover.

5.2.6 Installation in the back of a panel

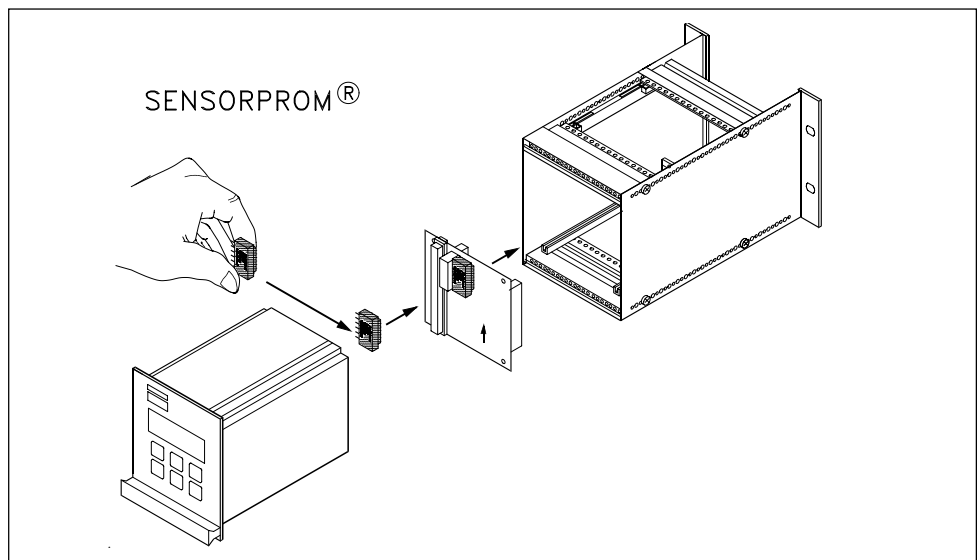

1. Mount the SENSORPROM® unit on the connection board as shown. The SENSORPROM® unit is supplied with the sensor.
2. Mount the connection board in the back of the enclosure.
3. Connect the cables as shown under "Electrical connection".
4. Mount the enclosure in the back of a panel with four screws.
5. Plug in the transmitter.

5.2.7 Installation in panel mounting enclosure (front of panel)

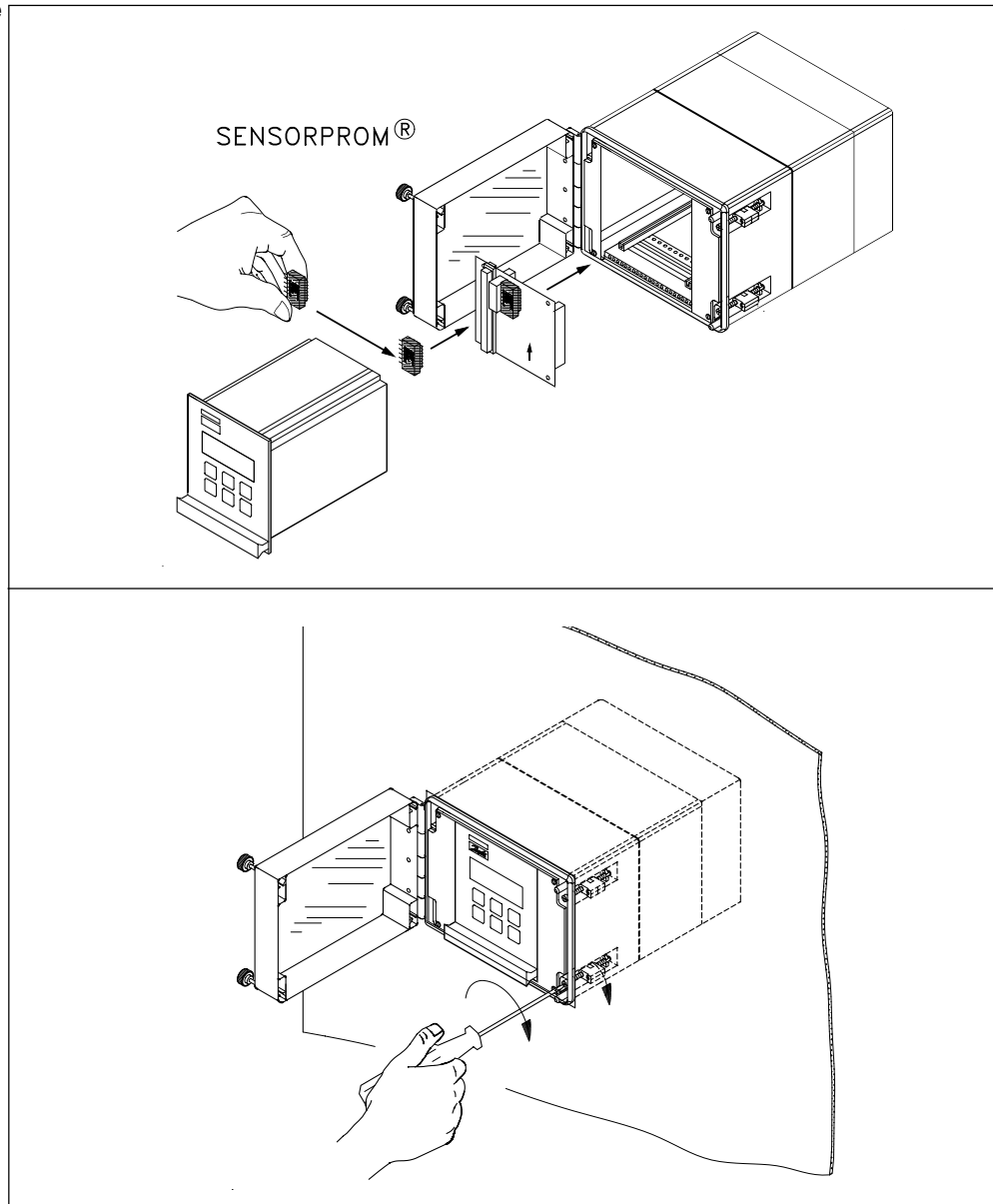

1. Mount the SENSORPROM® unit on the connection board as shown. The SENSORPROM® unit is supplied with the sensor.
2. Fit the enclosure in a cut out at the front of a panel. Fasten the four screws accessible at the front.
3. Connect the cables as shown under "Electrical connection".
4. Plug in the transmitter and close the cover.

5.2.8 Add-on modules

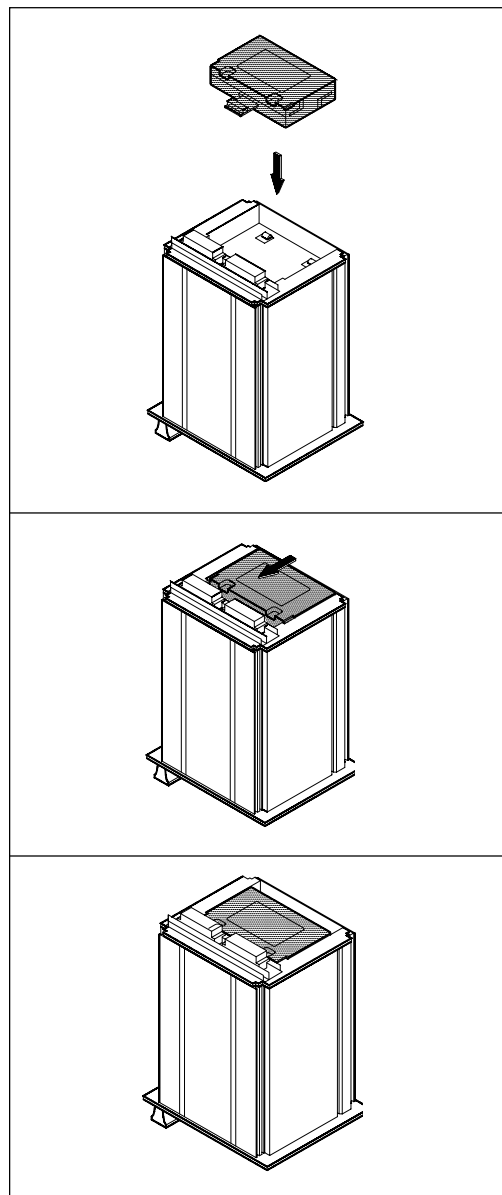

Unpack the add-on module and locate it in the bottom of the transmitter as shown.

Press the add-on module forward as far as possible.

The add-on module has now been installed and the transmitter is ready to be installed on the terminal box. Communication to the operator menu and electrical inputs and outputs are automatically established by power on.

5.2.9 Compact Ex-d version

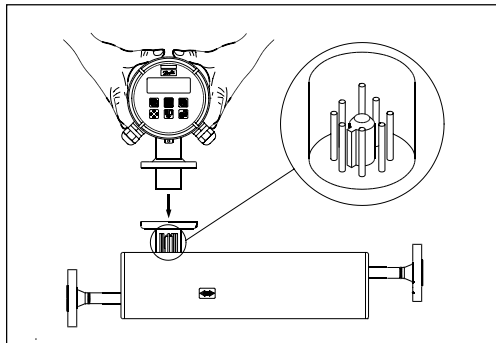

For compact (integral) installation mount the transmitter on top of the sensor interface. Make sure that it is correctly oriented (note the little tag). After placement, it can be turned 0-360°.

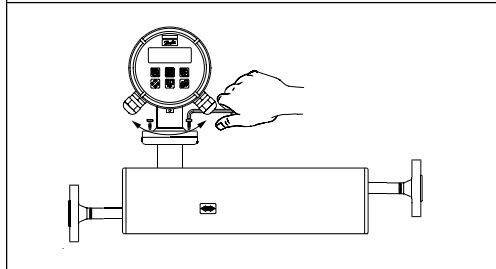

The transmitter is secured with 4 allen screws (allen key M4).

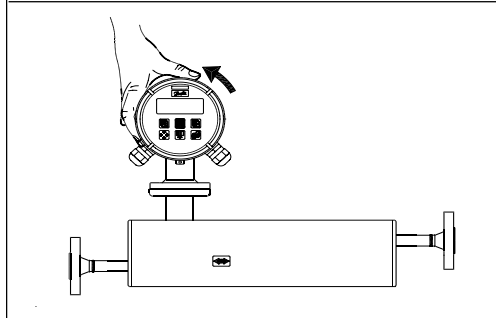

The terminals for inputs, outputs and power supply can be accessed by removing the front cover, turning it counter-clockwise.

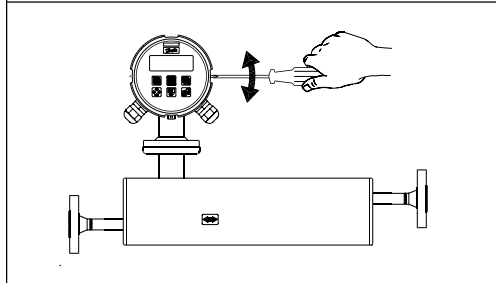

The display can be lifted off (i.e. with the tip of a screwdriver or similar) and the terminals are accessible.

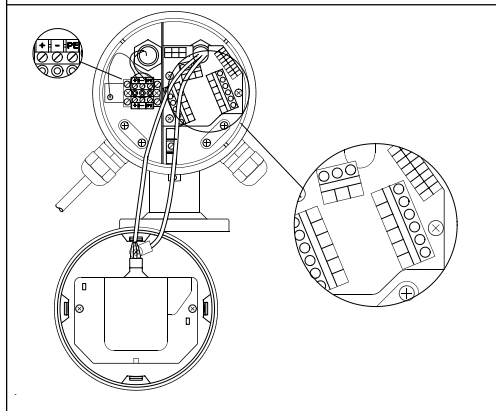

The intrinsic input and output cables must be secured by cable straps, so that they will remain in position should the terminal screws work loose.

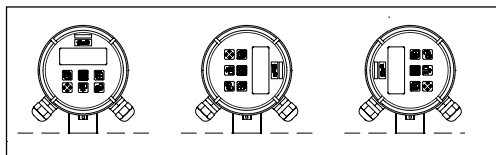

The display/keypad can be rotated in steps of 90°. Please note the little tag on the back of the display frame which must correspond to the nut on the converter body when the display/keypad is replaced. This is essential for obtaining optimum sealing.

5.2.10 Remote installation of multiple plug at the sensor

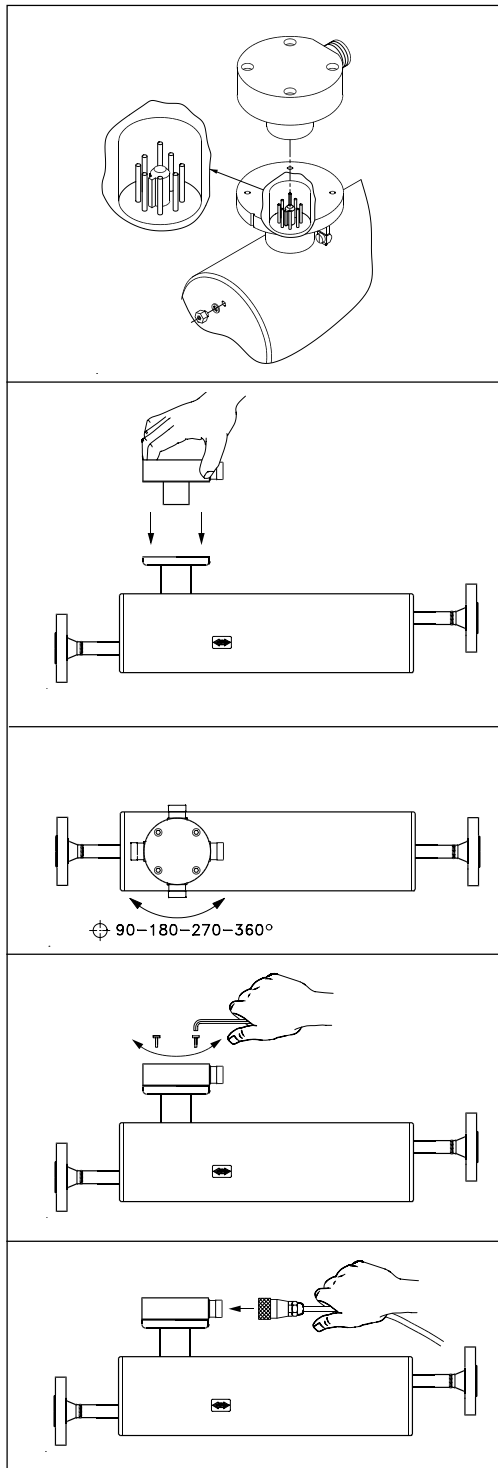

For remote installation mount the adaptor on top of the sensor interface. If not already mounted.
When fitting the multiple plug, please make sure that it is correctly oriented (note the little tap).

After placing, it can be turned 0 - 360°.

The adaptor can be oriented in 4 directions. Tighten the 4 screws with a 4 mm allen key to secure the adaptor. Mount the multiple plug in the adaptor and

tighten the glands on the plug to obtain optimum sealing. Note the wire colors when connecting the instrument. Refer to the diagram for electrical wiring, see "Electrical connection".

Installation of signal con.

5.2.11 Compact (Integral) Ex-d version
Location of the SENSORPROM® memory unit

The SENSORPROM® unit is normally factory-installed. To remove the SENSORPROM® unit, use the following procedure:

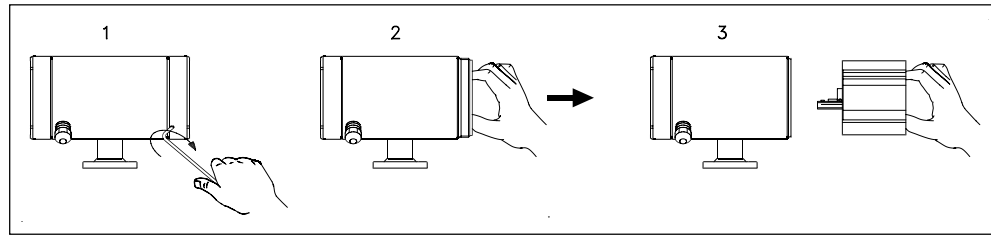

1. Remove the rear cover, by loosening the safety tap allen screw (M3), and turn the rear cover counter-clockwise.
2. Remove the electronics using the holes provided.

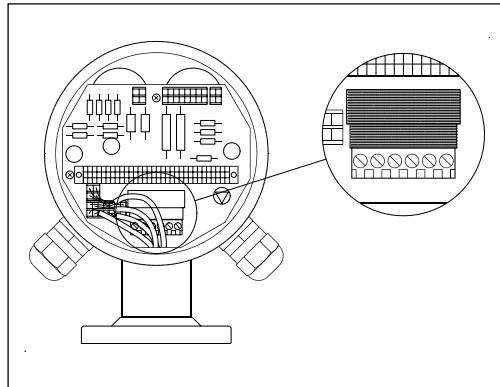

The SENSORPROM® unit is placed at the bottom of the housing. The SENSORPROM® unit can be installed/removed by screwing/unscrewing the 6 terminal screws connecting the SENSORPROM® unit. The label on the SENSORPROM® unit must face outwards.

**5.2.12 Compact (Integral)
Ex-d version
Installation of
add-on module**

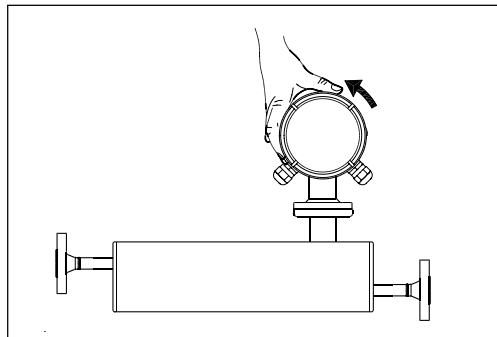

Remove the rear cover, by loosening the safety tap allen screw (M3) and turn the rear cover counter-clockwise.

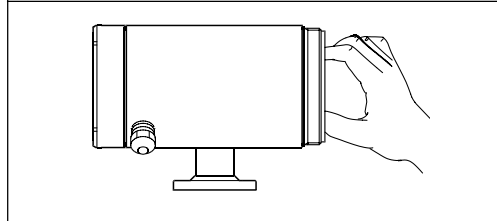

Remove the electronics using the holes provided.

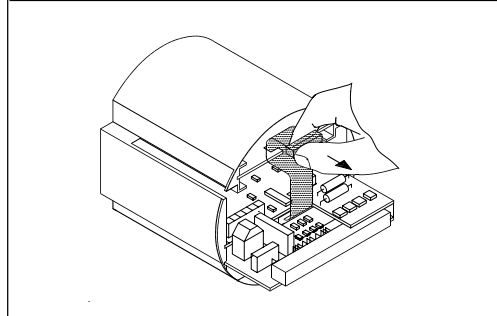

Remove the flat cable from the plate.

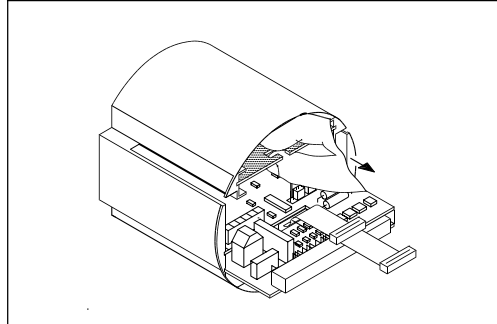

Remove the plate from the module bay.

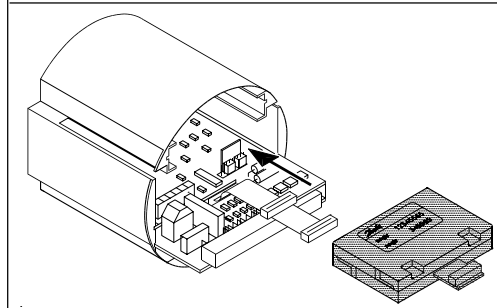

The add-on module is fitted at the bottom of the converter insert as shown. The label text on the add-on module should face up as shown.

The add-on module is fitted with the connector facing out of the enclosure.

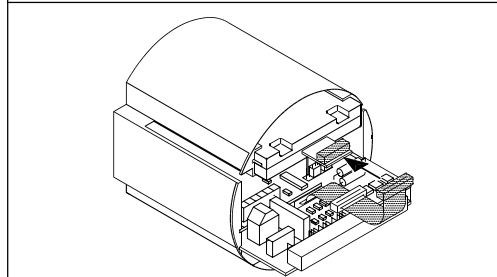

The add-on module can be pressed into position.

Connect the flat cable connector to the module and power up. The add-on module is automatically initialized. The menu's are now visible on the display/keypad of the Transmitter.



Warning

Ex-compliance of add-on module

When installing the add-on module in the Transmitter Ex-d, only Ex modules which have been approved can be used.

All modules, which can be used, have been clearly marked with the Ex-symbol and Ex-approval No.

Installation and wiring, instructions supplied with the module must be followed.

In case of service or installation of add-on module

If the electronics is to be replaced or an add-on module is to be installed, this can be done by dismantling the cover located in the back of the enclosure.

To reduce the risk of ignition of hazardous atmospheres, disconnect the equipment from the supply circuits before opening. Keep assembly tightly closed when in operation.